

# Waybill

Spring 2006

Mid West Region NMRA



## 39<sup>th</sup> Annual Mad City Model Railroad Show & Sale



# EXECUTIVE BOARD & CHAIRPERSONS OF MWR STANDING COMMITTEES

(Please contact the Secretary with any corrections fifteen (15) days prior to the next Waybill deadline.)

## Officers

### President:

Gary Children (1)  
2135 S 95th St  
West Allis WI  
53227-1418  
414.327.1666,  
csuperchief20@aol.com\

### Vice President:

Randy Williamson  
5929 Lakeview Rd ,  
Larsen WI 54947  
920.836.3211,  
pennsy@centurytel.net

### Treasurer:

Bob Sherman  
3705 Yukon Rd, Unit D,  
Brookfield WI 53045-2021,  
262.790-9830,  
paymaster@wisdivision.org

### Secretary:

Bert Lattan (2)  
145 Heathrow Ct  
Lake Bluff IL 60044  
847.295-795  
mwrsecy@comcast.net

### Immediate Past

**President :** Dick Cecil  
3131 N Cramer St  
Milwaukee WI 53211  
414.332-3729  
thececil@sbcglobal.net

## Directors-at-Large

Term Expires 2006

Bob Ginter  
4449 Charles St Apt. E,  
Rockford IL 61108  
815.399.6466  
rockfordunionstation@  
worldnet.att.net

Mike Hurlburt  
N7759 Laura Ln  
Elkhorn WI  
53121-2772  
262.742.3112;  
tngr@genevaonline.com

Ron Scharping  
6145 Plymouth St,  
Downers Grove IL 60516-1783  
630.968.0157  
sue\_ron\_scharping@comcast.net

Roger Wurtzel  
910 Chandler Ave  
Plover WI 54467-2269  
715.343.2776,  
rogini@charter.net

Term Expires 2007

Lynn Jasch  
1850 Adler Way  
Green Bay WI 54303  
920.499.1632,  
josh@gbonline.com

Bill Litkenhous  
2509 Windwood Dr  
Bedford IN 47421  
812.275.3634,  
mrlit@dmrtc.net

Barb Rothwell  
5667 Concord Dr,  
Fitchburg WI  
53575-1906  
608.835.7072,  
waybilleditor@charter.net

## Division Directors

### Calumet Division

Pat Mehegan  
3601 Valparaiso St  
Valparaiso IN  
46383-1971  
219.531.0944  
caseyjones999@juno.com

### Fox Valley Division

Richard Sweet  
11 Park Place Cir  
Hawthorn Woods IL  
60047-6613  
847.550.1399  
rsweet@pactiv.com

### Rock Island Division

(Inactive)  
Tom Rasmussen  
4514 12th St  
East Moline IL  
61244-4117  
309.796.0018  
track2@qconline.com

### Illinois Terminal Division

Joe Rich  
803 E Pembroke St Apt 4  
Tuscola IL 61953  
217.253.4958  
joerich\_2@mchsi.com

### Capitol Division

(Inactive)  
*Contact the Secretary*

### Illinois Valley Division

Marion Brasher  
425 W St Paul St  
Spring Valley IL  
61362.1858  
815.663.3411  
valleyrndhouse@aol.com

### Rock River Valley Division

Don Brindle  
3159 Far Hill Rd  
Rockford IL 61109  
815.874.6095  
donbridle@aol.com

### Winnebago Land Division

Todd Rebhahn  
3259 Old Military Rd  
DePere WI 54115-8630  
920.983.8384  
trebhahn@sbcglobal.net

### Central Indiana Division

Larry Gilbert  
6675 S 200 E  
Markleville, IN  
46056-970  
765.779.4039  
leghome@iquest.net

### North Shore & Western Division

Jim Spice  
10141 Yorkhouse Rd  
Beach Park IL  
60087-2405  
847.662.7267  
jimjet2@comcast.net

### South Central Wisconsin Division

Hank Brown  
622 Oak St  
Cottage Grove WI 53527  
608.839-4939  
trainguyz@charter.net

### Wisconsin Southeastern Division

Bob Gallegos  
PO Box 240914  
Milwaukee WI 53223  
414.350.7788  
dgallegos@wi.rr.com

### DuPage Division

Tim Schubert  
1278 Oxford Ln  
Wheaton IL 60187  
630.390.9757  
tijjr7@msn.com

(Continued on page 21)

- (1) Also Alternate RAC Representative
- (2) Also RAC Representative
- (3) The Achievement Program Manager and the Education Coordinator are appointed by the NMRA Education Department.
- (4) Committee and Convention Subcommittee Members appointed by the Region,. Does not include Division appointments to the Clinic, Convention, Internet, Membership and Publications Committees.

## Table of Contents – Spring 2006

MWR Officers & Standing Committees	2
Table of Contents	3
President's Report	3
Division Meet Schedule	6
Waybill Advertising	10
Waybill Schedule	10
Book Review	11
Spruce up your Caboose	12
Rockford Rail Show	14
RailFun 2006 & Registration	15
High Wheeler 06 Model Train Show	17
Join the NMRA	18
Committee Chairs	19

## Midwest Region of the National Model Railroad Association.

The Waybill is published 4 times a year:  
Winter – December, January, February  
Spring – March, April, May  
Summer – June, July, August  
Fall – September, October, November

Edited by: Barb Rothwell  
Mailing address for the Waybill entries:  
5667 Concord Drive  
Fitchburg, WI 53575  
waybilleditor@charter.net

## President's Report

by Gary Children, President MWR

Well here it is, 2006. I hope you all survived the holiday season and maybe even put a new something on your layout. Now that the holiday season is over, our region treasurer is preparing the tax papers, and the NMRA will be holding its winter board meeting the week of the 15<sup>th</sup>. The NMRA is just waiting for our Treasurer's address in order to send our part of the dues collected.

Now, here's some news from our region. The SCWD division had their rail school in January. It was very well done. Forty five kids learned about model railroading from a group of modelers showing them different parts of the hobby. The youth group chair had the kids build a car, add decals, weight it and do a test run.

The WISE division had a beginners meet with clinics showing participants how to do things as well as what is going on in the division. As I mentioned in my last report, we all have to get the younger generation and their parents involved in the hobby. I am also aware that other divisions do this during different times of the year. My thanks goes out to these divisions for doing their part. As NMRA members, please try and do what you can to get more people involved.

A lot of the divisions have train shows and this would be the perfect opportunity to recruit some new hobbyists. Some of the shows include: Trainfest in November for the WISE division, Mad City in February for the SCWD division, High Wheeler '06 for the Fox Valley division in March as well as the Rock River division model railroad show, also in March. All of these shows appear in the *Waybill* with their dates and times. All of our divisions work hard to put on these shows. Please show your

support by attending and helping to get more people interested in the hobby. I will do my part to help out as well.

I got the opportunity to work with Reid Kahrs during the SCWD division's rail school. I also did a clinic for the Fox Valley Division and in return, one of their members did a clinic for the WISE division. We will also be doing a clinic for the spring convention.

As a member of the Badgerland S Gaugers, I helped the Waukesha Gandy Dancers with a Winter Fest display in Waukesha, WI. Lionel of Milwaukee was also there to show the difference in the scales. Badgerland S Scale had a display of box cars from Z to G gauge. This was rebuilt to add a Z gauge and G gauge to the display. It took some time to get a Z gauge and G gauge in rail box cars. All of this was prepared in order to show the different size scales people can work with. It's really a show-and-tell to get people to talk about their likes and dislikes, and even more so, just to get people talking. You'd be surprised by how many people out there who have train set ups in their attic or closet. This was the perfect opportunity to try and get people started back up in the hobby.

Don't forget to vote in the region election. There are four positions available on the board of directors. These people are trying to help the region, so please vote. Also, the regional convention is this spring. This is a joint effort between the Fox Valley and DuPage divisions. Come and meet new people and have some fun. The convention committee has lined up a good program. Make sure to bring a model, or two, or three as well as some slides and pictures. We have two new co-chairs for the model contest. Let's give them a good work

out, they need the work. There is no money in the budget for layoffs. If you can help out in judging, half of your registration fee will be refunded.

Remember, model railroading is fun. I finished up painting 75 Preiser people in s scale and I didn't lose it, not totally anyways, but it was fun. See you all at one of the shows or the regional convention!



**TRAIN GUYZ**

Hank Brown  
622 Oak Street  
Cottage Grove WI 53527  
(608) 839-4939  
E-mail: [trainguyz@charter.net](mailto:trainguyz@charter.net)

WE CAN MAKE YOUR MODEL RAILROAD DREAMS COME TRUE

**Any interesting railfanning, or layouts you've seen lately? Have you gotten your AP award for author yet?**

**Here's your chance to put the two of them together, and provide an article for the Waybill.**

**Remember, if you can write an article, you shouldn't be afraid of a little more paper work, to get those AP points.**

# Division Schedule

## Calumet Division:

Contact: Al Kamm Jr, 815.469.2917

No meetings in December and January for information call: 1-815-469-2917

## Central Indiana Division:

Contact: Larry Gilbert  
765. 779.4039

## GTE (Formerly GATS) January 7-8 2006 - Indianapolis IN - Indiana State Fairgrounds

### April 23, 2006 (Sunday) - Danville - IN

4H Building, Hendricks County Fairgrounds (Building may change) Meet, Show and annual membership meeting. Open to the public with admission fee.

### May 7, 2006 – Lafayette

Layout tour for NMRA members and guests – no admission fees

### July 21-23, 2006 – Fortville, IN

By Air, By Rail Festival (displays of model train layouts, antique autos, hot air balloons , ultra light planes as well as food and craft booths. Open to the public – no admission fees

### Sept 30, 2006 – Bedford IN

National Guard Armory meet and train show. Open to public with admission fees.

## DuPage:

Contact: Rob Schiavone  
630.690.3262  
[robert\\_s\\_60188@yahoo.com](mailto:robert_s_60188@yahoo.com)

Location: Lisle Library  
777 Front Street  
Lisle, IL

## March 5, 2006

Program: David Liesse – British RR  
Contest: All NMRA Categories

## April 2, 2006

Program: TBA  
Contest: April Fools contest

Meetings starts at 1:30pm

## Fox Valley Division:

Contact: Richard Sweet [rsweet@pactiv.com](mailto:rsweet@pactiv.com).  
11 Park Place Circle  
Hawthorn Woods, IL 60047  
847.550.1399  
<http://www.foxvalleydivision.org/>

Division meetings are held from September through May generally on the 3rd Sunday of the month from 1:30 until 4:30 at the Gary Morava Recreation Center, 110 W. Camp McDonald Road, Prospect Heights, IL 60070. The center is 1 block west of the Camp McDonald and Elmhurst Road intersection. Monthly meetings feature a program discussion or clinic, a popular vote modeling category contest with cash prizes, refreshments and an occasional excursion. Contact David Leider for all excursion reservations at [sooauthor@netzero.net](mailto:sooauthor@netzero.net) or 847-253-7484. Include names and Phone #.

**March 4 & 5 - High Wheeler '06 Train Show** at Harper College Sports Center, located at the corner of Algonquin and Roselle Roads. 9:00 am until 5:00 pm. Bring your friends and family. Operating club and individual layouts, hobby shop and historical society exhibits. Donation \$7.00, Seniors \$6.00, ages 5-12 \$2.00, under 5 free. No regular March division meeting.

**April 23** - Annual business meeting and officer elections. 1:00 pm start. Clinic by David Leider. Enter the Maintenance-Of-Way car contest (with or without your gandy dancers) to show us how you keep the trains rolling on your pike?

**May 21** - Operating session excursion to Ted Schnepf's "Fox Valley O Scale" pike. See <http://users.foxvalley.net/~railsunl/FoxValley/> for reference. Reservations required.

**Illinois Valley Division:**

Contact: Marion Brasher  
(815)663-3411  
Email: valleyrnhouse@aol.com

Or

James Carrow  
2926 E 6<sup>th</sup> Rd  
LaSalle IL 61301  
(815)233-2527  
E-mail: Jcarrow@theramp.com

IVD Meets are conducted using the following format - Doors open at 12 noon, there is space and tables for members to set up swap tables, the meet starts at 1 PM and tours of model railroads in the area follow the meet (usually around 3 PM). The cost to attend our Meets is \$1.00 for all attendees

**March 12, 2006**, Peoria ReMax Bldg.

**May 21, 2006** Utica, Knights of Columbus Hall  
(call for more information)

**North Shore & Western Division**

Contact: Jim Spice  
(847) 662-7267  
jimjet2@comcast.net

Location: Glenview Public Library  
1930 Glenview Rd  
Glenview, IL

The Division meets from September to May, on the fourth Sunday of the month. Meetings are held in the Maynard Room, Glenview Public Library. The Library opens at 1:00 pm and meetings begin at 1:30 pm. From time-to-time meetings are followed by layout tours.

**March 26, 2006:** Monthly Meet  
Clinic: TBA  
Contest: Diesel & Other Locomotives

**April 23, 2006:** Monthly Meet  
Clinic: TBA  
Contest: Non-Revenue Cars  
(Caboose, MOW, Etc.)

**May 21, 2006:** Monthly Meet  
Clinic: TBA  
Contest: Favorite Train & Traction  
Election of officers for 2006-2007 season

These dates may change if they conflict with Library events. See the Division website (<http://home.comcast.net/~nswnmra/>)

**Rock River Valley Division:**

Contact: Joe Whinnery  
815-398-8973

Location: Midway Village and Museum Center, 6799 Guilford RD, west of Perryville and State St.  
Rockford IL Doors open at 12:30 with the meeting at 1:00.  
Donation is \$2.00.

**Dates:**

**March 5, 2006** – regular meet  
**March 23-24, 2006** – Train show & sale  
**April 2, 2006** – annual meeting  
**May 7, 2006** – Joint meet with SCWD  
**June 4-8, 2006** – Junket  
**July 2006** - Picnic

**South Central Wisconsin Division:**

Contact: Hank Brown  
608.839-4939  
Location: Fitchburg Community Center  
5510 Lacy Road  
Fitchburg WI  
Meeting times: 1-4pm

**Date: March 5, 2006**

Contests: Moving the Military

**April 2, 2006**

Contests: April Foolery

**May 7, 2006**

Joint meet with Rockford

**Illinois Terminal Division:**

Contact: Joe Skamel  
(217) 892-9740

Location: NA

Anyone interested in helping Joe start some activities, please contact Joe directly.

**Winnebago Division:**

Contact: Tod Rebhahn  
(920) 983-8384

Holding two meets each year. Spring meet usually includes a banquet and guest speaker, while the Fall meet is a less formal affair. All meets are open to everyone and NMRA membership is not required to attend. Check web site for more information:  
<http://wld.trainstuffllc.com/>

**Winnebago Division Club Meets:**

**Cedar Creek Railroad Club**

Weekly meetings are held on Wednesdays at 7:00PM in the Train Room at Lamm's Garden Center  
2708 Sherman Road  
Jackson, WI

**Central Wisconsin Model Railroaders, Ltd.**

- **Stevens Point/Plover WI Area** HO and N-scale modular layouts. The clubhouse is located in the basement of a restored Wisconsin Central Railway's depot in the Portage County Historical Society's Heritage Park, Plover. Meets Wednesdays at 7:00 p.m. Visitors are always welcome. For more information call the clubhouse at 715-342-7300 on meeting nights. You can also email Jerry Rohlinger or phone him at 715-341-2069, or call Don Anderson at 715-344-8545.

**Clipper City Model Railroad Club -**

**Manitowoc** - Iron Horse Barn - Expo Grounds - I43/ US 151

Meets 1st Thursday at 7:30 p.m. - For more information contact: Joe Lallensack

**Fond du Lac Model RR Club - Fond du Lac**

**Green Bay Area Model Railroaders Club (Newer Industries) - Green Bay WI**

**Hub City Model Railroaders - Marshfield** - Meet on the 3rd Thursday of each month except June, July and August, at 7:00 p.m. The clubhouse is located at 709 N. Chestnut Ave. For more information contact Keith Meacham or Gene Greenwald.

**Kettle Moraine Ballast Scorchers  
Railroad Club, Inc.**  
137 B North 6th Ave. West Bend, WI 53010

**Machickanee & Splinter Creek Model RR  
Club – Marinette, WI**  
Meets Wednesday at 7 p.m. at 1729  
Stephenson Street, Marinette, WI. A new  
layout is under construction. For more info e-  
mail Norman (Chic) Hartert.

**Neenah-Menasha Model RR Club - Neenah**  
- 323 West Forest Avenue. Open visitation the  
first Wednesday of the month, other  
Wednesdays by invitation only. For more info  
call 414-725-3967.

**Paper Valley Model Railroad Club -  
Kaukauna, WI**  
The clubhouse is located at W2221 Block  
Road, Kaukauna, WI. Club hours are Thursday  
7pm - 9pm and Saturday 1pm - 4pm.

**Plymouth Model RR Club - Plymouth WI**

**Rhineland RR Association - Rhineland  
WI** - Meets at various locations on  
Wednesdays at 7 p.m. and Saturdays 9 a.m. to  
noon. HO scale layout depicts the railroad  
operations in and around Rhineland from  
1930 to 1950. Visitors are always welcome.  
For more information contact Club President  
Tom Foerster at 715/479-4988.

**Rothschild, Schofield, & Weston Model  
Railroad Club- Rothschild, WI**  
The club meets every Wednesday night at 7pm  
in the basement of the Hobby Connection in  
Rothschild, WI. The club layout is open to  
visitors every Saturday afternoon until 5pm.

**Sheboygan Society of Scale Model RR  
Engineers -Sheboygan WI**  
Meets Tuesdays at 7 p.m. at the Railroad  
Lodge, 1001 N. 10th Street. 38 by 46-foot HO  
and HOn3 layout with double-tracked mainline  
and a 60-foot hidden staging yard. Visitors are  
always welcome and membership is open. For  
more information write to Club Secretary,  
Dick Pool at the above address or call the club  
on Tuesday evenings at 920-452-0166.

**Seymour Model Railroad Club - Seymour  
WI** - 209 Depot Street. Open house first &  
third Sunday of each month from 1-3 p.m. HO  
Scale. The layout is located in the former  
Green Bay & Western depot which was moved  
across the street and restored. For more info  
contact David Fairbanks, 323 Washington  
Street, Seymour WI 54165-1331.

**Tri-City Railroaders Association of  
Wisconsin Rapids, Wisconsin.**  
John Sawaska, President, 1010 21st. Avenue  
South, Wis. Rapids, WI 54495. Phone:715-  
421-4610. For further information or  
questions, e-mail John at js8542@wctc.net.  
The club meets at 6:30 PM on the 1st and 3rd  
Monday's of every month, September through  
May, at The Rapids Mall, 555 West Grand  
Ave., Wisconsin Rapids, WI.

**The Upper Michigan Central Model  
Railroad**, located in Escanaba, MI. A 25' by  
50' HO permanent layout, soon to be 45' by  
50', by adding the U.P.Shortlines layout from  
Marquette, MI. We also have a 20' by 9'  
traveling layout and an 8' by 3' and growing N-  
scale layout. Located in the basement of the  
8th Street Coffee House, 720 Ludington St., in  
Escanaba, MI. Meetings at 7:30 PM every  
Thursday. For info? Call Gary Stiles, 906-  
428-3472 or trainmaster@chartermi.net



**Waupaca Area Model Railroaders -**  
**Waupaca** More info: 715-258-5842.  
Meets on Thursdays at 7:30 p.m.

**Wisconsin & Michigan Model RR Club -**  
**Marinette WI** Meets Thursdays at 7 p.m. in  
the basement of the Elk's Club in Marinette,  
WI. The HO scale layout is 26' by 6'. Visitors  
are always welcome and membership is open.  
For more information contact, Dave Rickaby  
at 1031 Marinette Avenue, Marinette WI  
54143 or call 715-732-1318.

**WISE Division:**

Contact: Bonnie Janke [janke@execpc.com](mailto:janke@execpc.com)  
262.392.9698

Location: Best Western Midway Hotel  
5105 S Howell, Milwaukee, WI  
(unless otherwise noted)

Meeting time: 12:30-4pm

**Dates:**

March 19, 2006 - TBA  
April 23, 2006

The WISE Division sponsors monthly meets  
throughout Southeastern Wisconsin. Meets are  
on Sunday afternoons, and the public is always  
welcome. You'll be able to attend clinics on  
model railroading skills, enter modeling and  
photography contests, find a treasure or sell  
your railroad items at the SWAP meet, tour  
layouts at members homes.



## For Sale

Selling entire private collection of  
1,500 HO plastic freight cars,  
including many historical society  
issued cars. Also includes first 10  
issues of the NMRA Collector series  
kits in duplicate. NMRA journals  
from 1993 thru 2001; PRR Keystone  
1996 to present; B&O HS and C&O  
HS & WMHS society journals.  
Reading T&HS Bee journal & BRHS  
journals; and a map of Burlington  
/Great Northern System in 1950's  
32" x 18". Numerous RR steam  
photos; some stocks and bonds.

Items available on spreadsheet by e-mail:  
[j.e.whartoniv@dowcorning.com](mailto:j.e.whartoniv@dowcorning.com)  
or requests to:

John Wharton  
3266 Lakeside Drive  
Sanford, Mi 48657

## *Don't miss*

## **Spruce up your Caboose! Part II**

by: Mark N. Goedert

**In the Summer 2006 Waybill**

# Waybill Schedule

*Waybill current schedule:*

Fall (September, October, November)  
Winter (December, January, February)  
Spring (March, April, May)  
Summer (June, July, August)

*Deadline for submission to each issue is listed for the month previous to publication:*

*August 15<sup>th</sup> for the Fall issue  
November 10<sup>th</sup> for the Winter issue  
February 10<sup>th</sup> for the Spring issue  
May 15<sup>th</sup> for the Summer issue.*

*Submissions to: waybilleditor@charter.net*

## Waybill Advertising

At the last Board of Director's meeting, the MWR Board approved the submission of advertising for placement in the Waybill.

Effective June 1<sup>st</sup>, advertising will be accepted for placement starting in the Fall 2004 Waybill. The deadlines for camera ready ads will be the same as the copy deadlines stated above, (*please submit by e-mail if possible in MS Word format*). If you need ad composition, please contact the Waybill editor. Railroad related advertising only will be accepted for publication.

Advertising rates/year are as follow:

Full page	\$100.00
Half page	75.00
Quarter page	50.00
Business Card size	25.00

## Waybill Subscriptions

# Electronic Delivery

Send an e-mail to:

mwrsecy@comcast.net with your name, e-mail address, NMRA number and division. Use "Electronic Delivery Subscription" as the subject of your e-mail. Or, if you are reporting a change of e-mail address, use "E-Mail Address Change" as the subject of your e-mail.

## Mail Subscriptions

Subscribe for one or two years when you join the NMRA or renew your membership. A one-year subscription is \$6.00; a two-year subscription is \$12.00. New and renewal membership forms are available from the membership coordinator for your Division or from the NMRA website at <http://www.nmra.org/>. The website offers both online and mail-in options.

For more information about electronic delivery and regular mail subscriptions, visit the Midwest Region website at <http://www.mwr-nmra.org/>.

# Book Review

by: Mark N. Goedert

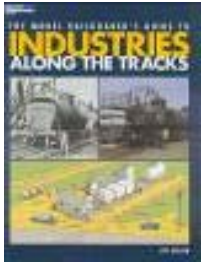

Title: "Industries Along the Tracks"

Author: Jeff Wilson

Publisher: Kalmbach Publishing

ISBN: 0-89024-582-7

Retail Price: \$19.95

Pages: 88

Pictures: Color / Black and White

"Industries Along the Tracks" is a basic look at the history, processes and how railroads interact with industry. The book does a great job covering the; Grain, Petroleum, Coal Mining, Automotive, Produce and Livestock industries. Author Jeff Wilson shows us how railroads interact with the six industries and presents them to us through explanatory diagrams, text and pictures.

The overall look and feel of the text is the high quality we expect from a Kalmbach book. All of the chapters have very good photos of buildings, structures, cars and sidings. The photos are a mixture of color and black and white depending upon the era. Sketches and diagrams compliment the photos to fill in the gaps of our knowledge. Some of the diagrams in the book did seem familiar to me, as if they were used in another text, however this feeling did not detract from the value of the book at all. The layout of the book is attractive and overall the text does not bog you down with details.

You can really describe this text as six mini-books covering industries served by rail. Each chapter could stand on its own as a basis for an

entire book. Jeff does an excellent job covering the basic information we need for each industry to model a convincing scene. The book does not focus on a single scale, anyone modeling from Z to G can use this book. The book provides us with a general history of each industry so the era covered is fairly wide. A chapter could have some pictures dating back as early as 1912 through the modern era. The coverage is not thorough, so you won't see 10 pictures from each decade but you will see a good summary of photos throughout the history of the industry.

This book was brought to my attention by a friend and structure aficionado Phil Schoenthal who recommended that I take a look at his copy. As I perused the book it was the nature of how each industry structure was covered that caught my attention and led to the purchase of my own. Each chapter is well structured to provide you not only with the history but a recommendation of how you can lay out the structure and spurs for a typical industry. Then Jeff talks about the specific cars you can spot at each industry with photographs of typical rolling stock. When you read into the discussion of rolling stock you will pick up nuggets on how to identify proper rolling stock for the industry. Even though I don't model the grain industry I can now discern if a hopper is designed to carry grain, sand or plastic pellets. In addition to industries Jeff provides an index of models available at press time to emulate structures for various industries. The list of model kits can be found as an appendix in the back of the book.

If you are in the process of building a layout, module, or diorama this book can be very helpful in building an accurate industry. Each chapter has enough information about each

industry to build a convincing scene. Additionally Jeff provides side bars with additional suggested readings to further the depth of your knowledge for some but not all industries in the book. I was not wholly interested in some of the chapters but I did find them to be an interesting read. You could also use the text as a “touch up” for an industry already on your layout and even improve how the industry is switched from an operators point of view. To say this book is for planners or scenery builders misses some of the additional value the text can provide.

I recommend “Industries Along the Tracks” for the quality and history of industries served by rail. This book will appeal to most modelers and planners building a layout or scene. If you thought twice about buying this book I hope you will reconsider and add it to your modeling library.

⊗

### **Modeling Hands On Spruce up your Caboose! Part I**

by: Mark N. Goedert  
Photos by the Author

With time for model work at a premium it can be satisfying to work on a small project that will be completed by the end of the evening. I took a look at a newly acquired Atlas model caboose and saw a few quick upgrades to take a good model make it look even better. Pictured is the Atlas Extended Vision Caboose, this will be the basis of our discussion. The Chessie caboose is used as an example but this article will apply to any version of the Atlas Extended Vision Caboose model.

### **Step Detail:**



Plano detail glued to the top of the existing caboose steps.

I unpacked the detail parts and read the instructions that came with the Plano steps. I thought that it would not be too hard to follow the recommended installation method and so I gave it a try. This first method is where we will apply the step detail directly to the model and not cut out the plastic or do anything fancy.

- (1) Use the small Xuron cutters to remove the metal detail steps from the spruce, note that the lower step is smaller than the upper step.
- (2) After removing the parts from the spruce I used a small file to smooth out any burs the parts may have. Be careful when filing because you could bend the detail.
- (3) Lay the step detail in place to check the fit. This should be done for each step on the caboose. If the step does not fit, file any burs or protrusions that are affecting a good fit.
- (4) With the step detail in place apply styrene or liquid plastic cement on top of the detail with a brush. Let the cement soak in between the metal grate into the paint.

The cement softened the silver paint to allow the step detail to sit in the paint. With the cement dry the step details are now fixed firmly in place.

### Step Detail Advanced Installation:

Since the basic installation went so easy I decided to up the ante a bit. Adding some complexity to the installation would be to allow see through step details. This involves some careful cutting and gluing but I found that the see through steps look really nice. I also decided to try the caboose steps because you don't have to bend the steps to install them, I figured that it would not be too challenging.

(1) I started the installation by cutting out the steps from the model to make room for the Plano parts.

(2) Use the small Xuron cutters to nibble away at the steps. Be careful so as to not scratch the back of the step. Also do not cut out the entire step out but nibble until you have about 1/8<sup>th</sup> of an inch ledge around the step pocket.

(3) Next take a Xacto #11 blade and carefully remove more plastic from the step until you have about 1/32<sup>nd</sup> to 1/8<sup>th</sup> of an inch sill around the edge of what used to be the step. Test fit the steps several times during this process. I found that the step detail is very close but not a snug fit in the step well.

(4) Take the Plano step detail and apply some thick Cyanoacrylate to the back side on what will be the bottom of the step. Lay the step in place on the caboose. Once the initial glue has set use an applicator (.12 brass wire for example) to apply more glue on the bottom of the step to reinforce the joint between the metal and the stair well.

(5) After the glue is dry use some silver paint to touch up the area you carved out. Also use the paint to cover up any scratches on the back side of the step.

### Bill of Materials:

- Atlas #1994-4 - Extended Vision Caboose
- Detail Associates #6206 - Air Hoses
- Kadee #58 - Scale Coupler
- Plano #454 - Extended Vision Caboose End Platform and Steps
- Cyanoacrylate Adhesive
- Plastruct or Testors liquid plastic cement
- Testors Silver paint
- Polly Scale Grimy Black, Roof Brown

### Tools:

- Testors (Xuron) small cutters, Tweezers
- Xacto knife with #11 blade, Sm flat file

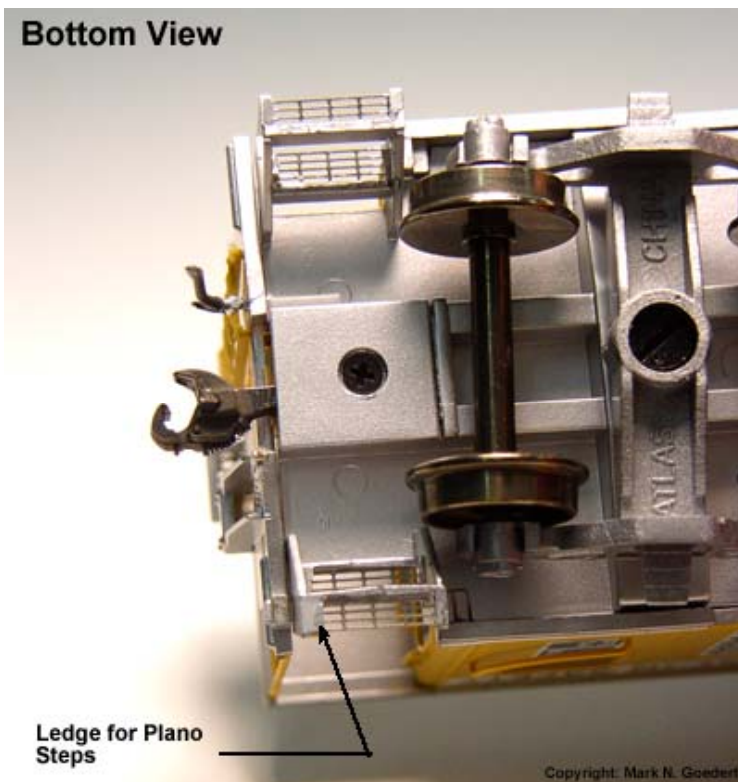

ROCK RIVER VALLEY DIVISION - NATIONAL MODEL RAILROAD ASSOCIATION

# ROCKFORD MODEL RAILROAD SHOW & SALE

NEW & BIGGER  
LOCATION !!!

FREE PARKING

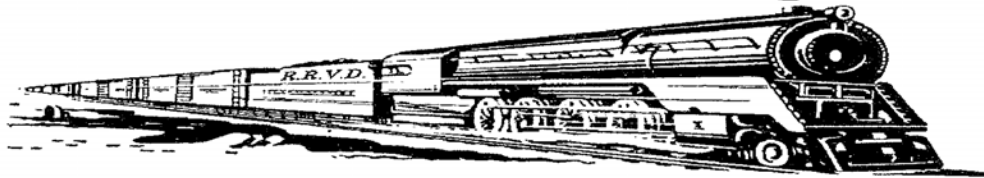

**HARLEM HIGH SCHOOL**  
9229 N. Alpine Road  
(1/2 mile south of Rt. 173 )  
Machesney Park, IL (Rockford)

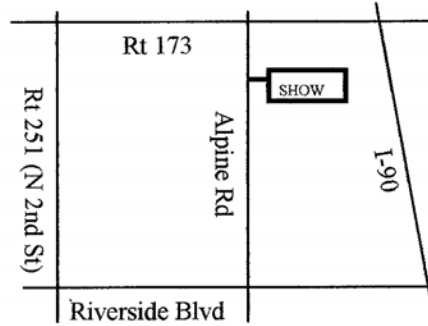

**MARCH 25, 2006 10 AM-5 PM**

**MARCH 26, 2006 10 AM-4 PM**

**44,000 sq ft of layouts, displays,  
modeling demonstrations and vendors with new/used train items  
and memorabilia. For more info e-mail [rrvdss@comcast.net](mailto:rrvdss@comcast.net)**

**\$5 Donation**

(under 12 years and uniformed Scouts free)

# RailFun 2006

The DuPage and Fox Valley Divisions jointly invite you to attend **RailFun 2006**, the Midwest Region's annual convention to be held at the **Hyatt Regency Woodfield** in **Schaumburg, Illinois, April 28-30, 2006**. We'll be featuring the area's collection of fine layouts for both tours and operating sessions, along with clinicians from across the country. We also will offer a noteworthy non-rail program for those whose interests lie in directions other than the rails.

As has become customary in our area, we will offer a Sunday brunch rather than a Saturday banquet, giving you the chance to check out Chicagoland's fine dining establishments. In addition to the hotel restaurant, there are three restaurants across the parking lot. Woodfield Mall, the world's largest indoor mall at the time it opened, is across the street, with a number of other restaurants within and surrounding it.

Of course, we'll have the usual activities for a Midwest Region convention: the model contest, the photo contest, and our time-honored auction. Bring down all those extras you've been accumulating and see if you can get a few bucks for them!

Circumstances in the lives of various volunteers have prevented the convention web site from being completed before this issue of the *Waybill* goes to press, but it will be available very soon, (maybe even by the time you're reading this). Link to the convention site from the region's web site ([www.mwr-nmra.org](http://www.mwr-nmra.org)) to keep up with the latest information.

We're looking forward to having you join us in April. Updates will be posted on the convention web site, as well as in the next issue of the *Waybill*. In the meantime, if you have any questions **contact Dave Liesse** at [NMRADave@comcast.net](mailto:NMRADave@comcast.net) (preferred) or (630) 554-2755.

Convention Website: <http://www.foxvalleydivision.org/railfun/>

Registration form: <http://www.foxvalleydivision.org/railfun/registrationform.htm>

**RAIL FUN '06 (28-30 April 2006)**

**Registration**

Primary Registrant \_\_\_\_\_

Additional Names \_\_\_\_\_

\_\_\_\_\_

\_\_\_\_\_

Address \_\_\_\_\_

Email Address \_\_\_\_\_

Evening Phone \_\_\_\_\_ NMRA # \_\_\_\_\_

	<u>Early</u> <sup>1</sup>	<u>Regular</u> <sup>2</sup>	<u>#</u>	<u>Total</u>
Full Fare	\$45	\$50	_____	_____
One Day	\$40	\$40	_____	_____
Non-Rail/Youth	\$25	\$25	_____	_____
Non-Member Fee <sup>3</sup>	\$10	\$10	_____	_____
Sunday Brunch	\$18	\$18	_____	_____
			<b>TOTAL</b>	_____

Number that wish to participate in Friday night operating sessions \_\_\_\_\_

Make checks payable to DuPage Division, NMRA

Mail to: Registrar, Rail Fun '06  
PO Box 271  
Lombard, IL 60148

- <sup>1</sup> Early registration rate applies if postmarked BEFORE 1 Mar 2006
- <sup>2</sup> Regular registration rate applies if postmarked ON OR AFTER 1 Mar 2006
- <sup>3</sup> Non-Member Fee applies if primary registrant is not an NMRA member

Operating session information and signup sheets will be sent to those indicating interest once the list of hosts is confirmed. Priority will be based on postmark of this registration form.

For hotel reservations, contact the hotel directly: Hyatt Regency Woodfield, 1800 E. Golf Rd., Schaumburg, IL 60173-5004 at 847-605-1234 or 800-233-1234 (fax 847-605-0328).



*High Wheeler '06*

# Model Train Show

Saturday & Sunday

**March 4 & 5**

9:00 am 'til 5:00 pm

Harper College Sports Center

Algonquin & Roselle Roads

Palatine, Illinois

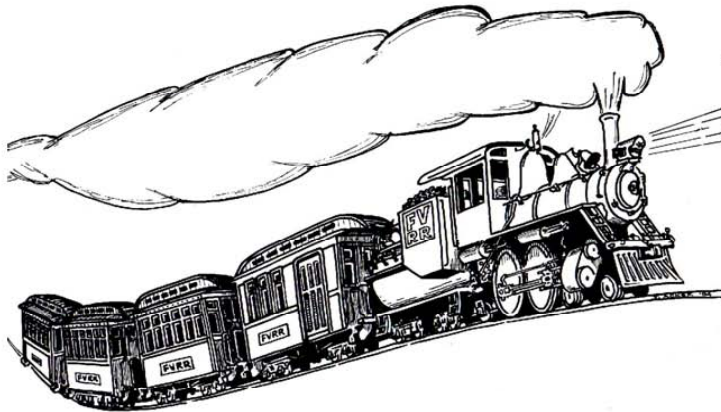

**All Scales Represented**

**Operating Layouts**

**Hobby Shops**

**Distributors**

**Manufacturers**

**Technical Groups**

**Historical Societies**

**Videos**

**Snack Bar**

**Door Prizes**

**Free Parking**

**Handicap Accessible**

*High Wheeler '06*  
is sponsored by the  
**Fox Valley Division**  
of the  
**National Model Railroad  
Association**

<http://www.foxvalleydivision.org/>



Not a Swap Meet  
or Flea Market

Donation.....	\$7.00
Seniors 65 & over.....	\$6.00
Ages 5 thru 12.....	\$2.00
Under 5 years of age...	Free

# Introducing the best deal in model railroading.

**Join the NMRA for 6 months for just \$9.95\*!**

- ◆ Have easy access to one of the world's largest railroad libraries...which includes over 100,000 prototype photos, 6,000 books, and over 50,000 modeling, prototype and historical society magazines
- ◆ Experience the fellowship and fun of getting modeling help and discussing the hobby with other members in your area
- ◆ Receive reduced rates on special insurance for your layout or collection
- ◆ Get admission to local model railroad meetings and events
- ◆ Receive 6 monthly issues of *Scale Rails* magazine
- ◆ Have access to standards information and data sheets
- ◆ Be a part of programs like "Modeling With The Masters," Pike Registry, Estate Counseling, contests, clinics, the Achievement Program and more!

Visit [www.nmra.org](http://www.nmra.org) to see what you're missing!

## Sign me up!

Fill out this form, include your payment of \$9.95 (U.S. funds only) and mail it to: NMRA - Rail Pass Membership, 4121 Cromwell Road, Chattanooga, TN 37421-2119. Or sign up online at [www.nmra.org](http://www.nmra.org).

Name \_\_\_\_\_

Address \_\_\_\_\_

City/State/Zip \_\_\_\_\_

Phone (\_\_\_\_\_) \_\_\_\_\_

Email \_\_\_\_\_

Check       Credit card

Credit Card # \_\_\_\_\_

Credit Card Exp. \_\_\_\_\_

Signature \_\_\_\_\_

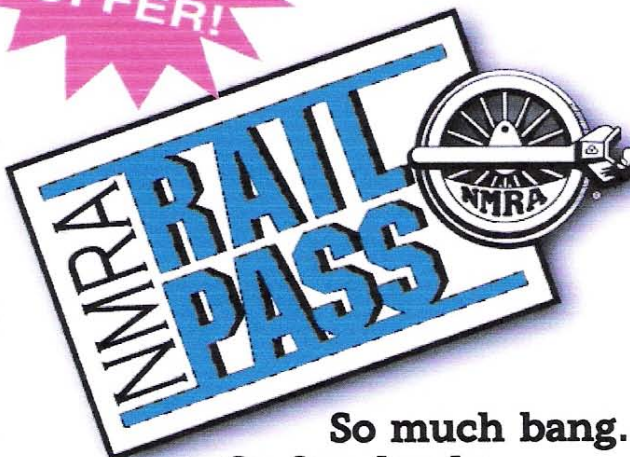

\*Rail Pass offer is good in the U.S. only and is for new members and those who have not been NMRA members for two years or more. Individuals can only join at Rail Pass rates one time; membership renewal will be at the regular membership rate. Rail Pass members can vote, attend conventions and participate in contests, but cannot hold office and will not receive a New Member Pak.

**So much bang.  
So few bucks.**

(Continued from page 2)

### MWR Committee Chairmen

#### **Achievement Program (3)**

Bill Myers  
5908 E 169th St  
Noblesville IN 46060  
317. 773.7159  
bmyers31@aol.com

#### **Audit**

Brian Cassidy  
824 Tommark St  
Green Bay WI 54304  
920. 498.0562  
brian-cassidy  
@sbcbglobal.net

#### **Clinic Clearing House**

Mike Hurlburt  
N7759 Laura Ln  
Elkhorn WI 53121  
262. 742.3112  
tngr@genevaonline.com

#### **Convention**

Reid Kahrs  
286 Woodland View Ct  
Colgate WI 53017  
262. 628.8489  
rkahrs@charter.net

#### **Education**

**Coordinator (3)**  
Ross Stark  
1729 Clyde Dr  
Naperville IL 60565  
630.983.1729  
j\_ross\_stark@hotmail.com

#### **Election**

Don Cook  
2500 10th St  
Waukegan IL 60085  
847. 249-4230

#### **Estate Counseling**

Calvin Krasonya  
414 E Mill St Apt 3  
Plymouth WI 53073  
920. 893-9552  
kcalvin@excel.net

#### **Internet**

Randy Williamson  
5929 Lakeview Rd  
Larsen WI 54947  
920. 836-3211  
pennsy@dcentury.net

#### **Long Range Planning**

Richard Cecil  
3131 N Cramer St  
Milwaukee WI 53211  
414. 332-3729  
thececil@sbcbglobal.net

#### **Membership**

Ron Scharping  
6145 Plymouth St  
Downers Grove IL 60516  
630. 968-0157  
sue\_ron\_scharping  
@comcast.net

#### **Nominating**

Jim Wilhite  
4823 Buttercup Way  
Anderson IN 46013  
765. 644-1887  
jwilhite@netdirect.net

#### **Promotions & Special Projects**

Randy Williamson  
5929 Lakeview Rd  
Larsen WI 54947  
920. 836-3211  
pennsy@century.net

#### **Publications**

Barb Rothwell  
5667 Concord Dr  
Fitchburg WI 53575  
608. 835-7072  
waybilleditor@charter.net

#### **Youth**

Capt Al Nelson  
1661 Atlanta Cir  
Manitowoc WI 54220  
920. 682-6787  
captal87@aol.com

### MWR Committee and Convention Subcommittee Members (4)

#### **Election & Internet**

Bert Lattan  
145 Heathrow Ct  
Lake Bluff IL 60044  
847. 295-7959  
mwrsecy@comcast.net

#### **Nominating**

Reid Kahrs  
286 Woodland View Ct  
Colgate WI 53017  
262. 628-8489  
rkahrs@charter.net

#### **Nominating**

Jim Spice  
10141 Yorkhouse Rd  
Beach Park IL 60087  
847. 662-7267  
jimjet2@comcast.net

#### **Model Contest**

Sean Lamb  
6218 Birch Hill Dr  
Madison WI 53711  
608. 271-9756  
mwrmodelcontests  
@riptrack.net

#### **Model Contest**

Chris Roeben  
3590 Breckenridge Ct #4  
Fitchburg WI 53713  
608. 278-8361  
croeben@charter.net

#### **Photo Contest**

Ingrid Drozdak  
4850 W Ainslie St  
Chicago IL 60630  
773. 545-5936  
ingridtreelay@  
sbcbglobal.net

#### **Auction**

Dave Poquette  
5665 N Bay Ridge Ave  
Whitefish Bay WI 53217  
414. 906-0678  
dpoquette@wi.rr.com

#### **Non-Rail**

Diane Gallegos  
PO Box 240914  
Milwaukee WI 53223  
414. 350-7788  
dgallegos@wi.rr.com

#### **Non-Rail**

Bonnie Janke  
W330 S7775 Country Ln  
Mukwanago WI 53149  
262. 392-9698  
yjanke@wi.rr.com

#### **Non-Rail**

Lynn Jasch  
1850 Adler Way  
Green Bay WI 54303  
920. 499-1632  
josh@gbonline.com

- (1) Also Alternate RAC Representative
- (2) Also RAC Representative
- (3) The Achievement Program Manager and the Education Coordinator are appointed by the NMRA Education Department.
- (4) Committee and Convention Subcommittee Members appointed by the Region,. Does not include Division appointments to the Clinic, Convention, Internet, Membership and Publications Committees.

SCWD  
5667 Concord Drive  
Fitchburg WI 53575-1906

Non-Profit  
Organization  
Permit No 1543  
US Postage Paid  
Madison WI